

oakheart

£850 Per Month

Per Month

Manchester Road, Ipswich





A recently refurbished two-bedroom first-floor apartment, ideally located within easy reach of Ipswich town centre and local amenities.

The property offers a spacious living area, providing a comfortable and versatile space for both relaxing and dining. The accommodation further comprises two well-proportioned double bedrooms, making it ideal for

professionals, couples.

The apartment has been recently refurbished throughout, presenting a modern and well-maintained interior. Additional benefits include off-street parking, adding convenience and practicality.

Well positioned for transport links and everyday amenities,

this is a well-presented apartment offering comfortable and convenient living in a popular location.











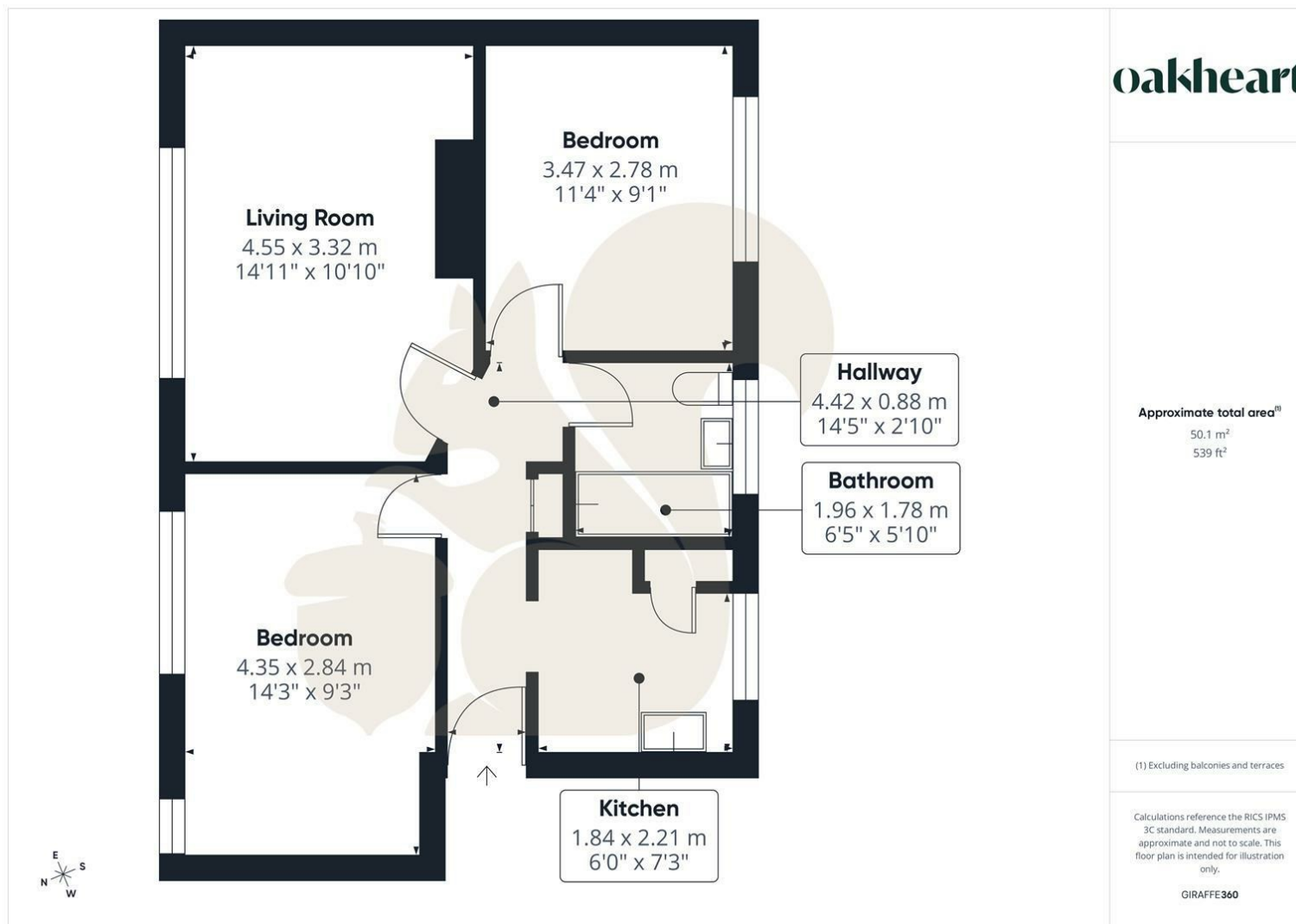



**oakheart**

Local Authority:  
Ipswich

Tenure:

Council Tax Band:  
A

### Energy Efficiency Rating

	Current	Potential
Very energy efficient - lower running costs		
(92 plus) <b>A</b>		
(81-91) <b>B</b>		
(69-80) <b>C</b>	74	74
(55-68) <b>D</b>		
(39-54) <b>E</b>		
(21-38) <b>F</b>		
(1-20) <b>G</b>		
Not energy efficient - higher running costs		
<b>England &amp; Wales</b>	EU Directive 2002/91/EC 	

Agents Note: Whilst every care has been taken to prepare these particulars, they are for guidance purposes only. All measurements are approximate and are for general guidance purposes only and whilst every care has been taken to ensure their accuracy, they should not be relied upon.

Oakheart Ipswich Lettings  
01473 251 907  
ipswichlettings@oakheart.co.uk  
12 Upper Brook Street, Ipswich, Suffolk, IP4 1EF

**oakheart**